



Transforming Healthcare Spaces Through Design, Partnership and Industry Insight

Case Study | Culinary Health Center



Project specs:

Location: Las Vegas, Nevada

Square footage: 97,230 square feet (58,300 SF 1st Floor / 38,930 SF 2nd Floor)

Scope: Exam rooms, waiting areas, staff lounge, telehealth rooms, call center, infusion bays, conference room and classrooms

Expanding Access to Care Through Thoughtful Design

When Culinary Health Center set out to launch its newest facility in Las Vegas, the goal was to create a highly functional, patient-centered environment capable of supporting a full range of medical and wellness services. The resulting Craig location spans nearly 100,000 square feet across two levels and offers an integrated care experience. The location offers primary care, pediatrics, dental, vision, physical therapy, radiology, behavioral health, lab services and more, all in a single, modern facility.

To bring the space to life, Culinary Health Center sought a partner with deep healthcare expertise and a proven ability to manage complex, large-scale projects. Through a referral from CNECT, an affiliate of Premier, Inc., one of the nation's largest healthcare improvement companies and GPOs, Culinary Health Center engaged the Workspace Interiors team at ODP Business Solutions® to lead the



furniture planning and implementation. Thanks to CNECT's affiliation with Premier, their members benefit from more than \$86 billion in purchasing power and access to an outstanding portfolio of contracts. This included several key furniture manufacturers specified for this project and others completed with ODP® since the partnership began in 2016.



ODP Business Solutions Workspace Interiors® team worked to deliver a comprehensive, end-to-end solution, including everything from product selection and design renderings to procurement, vendor coordination, delivery and post-installation clean-up. The result is a modern, adaptable healthcare space that supports the daily demands of patient care while offering staff a comfortable and efficient working environment.

Healthcare-focused, design-driven

The Workspace Interiors team took a collaborative approach from the start of the project, working closely with the architecture and design firm so that the furniture selections, finishes and space configurations complemented the building's layout and functional needs.

After discussions, it was decided that the interior of the facility needed to meet a diverse set of requirements, including clinical durability, patient comfort, staff productivity and aesthetic appeal. The Workspace Interiors designer at ODP Business Solutions® applied their knowledge and previous experience in the healthcare industry to deliver spaces that aligned with those expectations while working within project timelines and budget targets.



The Workspace Interiors team provided:

- Full furnishing of patient-facing and staff spaces across two floors
- Design planning, product selection and layout renderings
- Custom product sourcing aligned with timelines, aesthetics and budget parameters
- Contract pricing through CNECT
- Vendor coordination, delivery oversight and professional installation
- End-of-project site clean-up and waste removal

Driving value through strategic execution

By leveraging the buying power enabled through the CNECT GPO, Workspace Interiors secured competitive pricing across a wide range of furniture categories, from modular workstations and wire shelving to reception seating and private office furnishings. This consistency helped Culinary Health Center stay within budget while achieving its design and functionality goals.

The project also benefited from Workspace Interiors national network of over 300 vetted installation professionals. Each is held to quality standards and coordinated by an experienced project operations team, providing smooth, on-site execution and professional delivery.

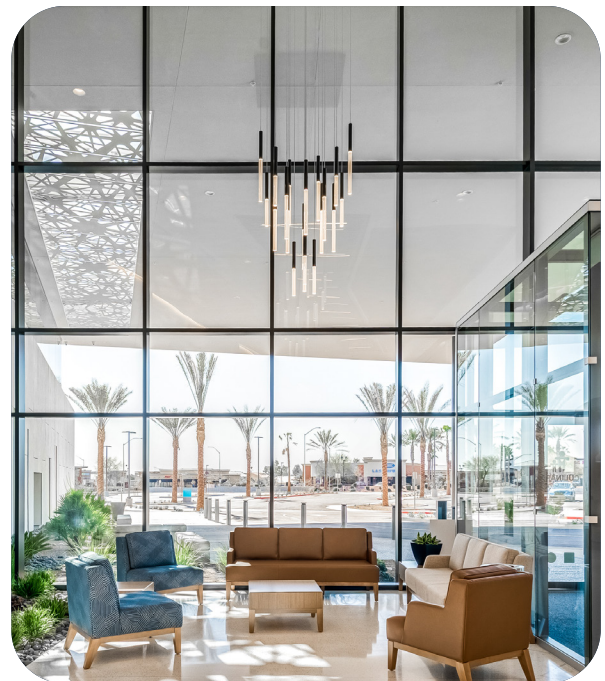

“By managing everything from design and product selection to delivery and installation, we made it easy for Culinary Health Center to focus on what matters most—patient care,” said Lindsey Johnson, ODP Business Solutions Workspace Interiors®.

Project outcomes

The Culinary Health Center – Craig project in Las Vegas was delivered on time and on budget. From initial concept through final installation, the project spanned approximately 12 months.

The facility's furniture solution supports the daily activities of medical providers, administrators and patients alike and reflects a deep understanding of the operational realities of modern healthcare delivery.



Key outcomes included:

- Complete furnishing and installation across clinical, administrative and public-facing spaces
- Timely coordination of delivery, setup and on-site support
- Product solutions aligned with clinical workflows, infection control standards and staff comfort

Every element—from layout precision to product durability—was selected to uphold Culinary Health Center's standards while meeting the practical demands of a modern care facility.





A trusted partner in healthcare design

The Culinary Health Center – Craig project underscores the impact of aligning design strategy with operational proficiency. From initial planning to final installation, ODP Business Solutions Workspace Interiors® integrated team of professionals brought forward the insight and resources needed to successfully execute a project of this scale and complexity.

By combining sector-specific knowledge, access to GPO-based pricing through CNECT and a coordinated national installation network, Workspace Interiors demonstrated its ability to deliver reliable, end-to-end support for healthcare environments.

As providers continue to evolve toward more integrated, patient-first models of care, facilities like Culinary Health Center – Craig offer a compelling example of how thoughtful design and experienced implementation can support healthcare innovation, one space at a time.

[Learn more.](#)

877.543.0944 | info.info@workspaceinteriorsod.com
workspaceinteriorsod.com



Contact us today.

Name:

Phone:

Email:

